

Liquid Level Sensor WS101-LL-10M

Measurement range: 0-300 meters (optional)
 Measure accuracy: 0.2%FS, 0.5%FS
 Output signal: RS485 2-wire Modbus
 Temperature drift: 0.03%FS/°C
 Power supply: 12-36VDC
 Power consumption: 0.48W
 Medium temperature: -10~50°C
 Protect level: IP68
 Current load capacity ≤500Ω
 Voltage output resistance ≤510Ω
 Measurement: Water, oil, etc.

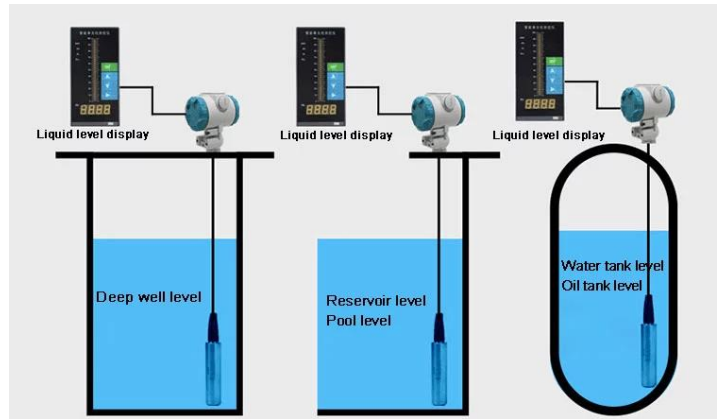

Features & Benefits

Signal Line Specification	2wire/3wire	liquid level sensor	liquid level sensor
Zero Drift	liquid level sensor	±0.02%FS/°C	liquid level sensor liquid level sensor
Thermal Sensitivity Shift		±0.02%FS/°C	liquid level sensor liquid level sensor
Longterm Stability (1 Year)		±0.1%FS	liquid level sensor liquid level sensor
Frequency Response (-3dB)		3.2kHz	liquid level sensor liquid level sensor
Compensated Temperature		-20~+85°C	liquid level sensor liquid level sensor
Medium Temperature sensor	liquid level sensor	-10~+85°C	liquid level sensor liquid level sensor
Overload Pressure	liquid level sensor	200% FS	liquid level sensor liquid level sensor
Testing Range(mH2O)	liquid level sensor	0.5 1 2.5 5 10 20 50 100 200 300 400 500 600	

- Excellent resistance against impact, overload, shock and erosion
- Efficient lightning protection, strong anti RFI&EMI protection
- Advanced digital temperature compensation and wide working temperature scope
- High sensibility, high accuracy, high frequency response and long-term stability



Groundwater level measurement



Reservoir water level measurement



Water level measurement



Sewage tank water level measurement